

Please read and save these instructions. Read through this owner's manual carefully before using product. Protect yourself and others by observing all safety information, warnings, and cautions. Failure to comply with instructions could result in personal injury and/or damage to product or property. Please retain instructions for future reference.



## 660 LB. DOUBLE-SCISSOR LIFTING TABLE CART

### FOR CUSTOMER SERVICE

Technical Question?

**CALL 1-866-458-2472**  
**customerservice@oem-tools.com**

### UNPACKING

After unpacking the unit, inspect carefully for any damage that may have occurred during transit. Check for loose, missing, or damaged parts. If any damage is observed, a shipping damage claim must be filed with the carrier. DO NOT use the OEMTOOLS® 24789 660 Lb. Double-Scissor Lifting Table Cart if broken, bent, cracked or damaged parts (including labels) are noted. Any 660 Lb. Double-Scissor Lifting Table Cart that appears damaged in any way, operates abnormally, or is missing parts should be removed from service immediately. If you suspect that the Table Cart was subjected to shock load (a load that was dropped suddenly, unexpectedly, etc.), immediately discontinue use until it has been checked by a factory authorized service center.



### **⚠ WARNING**

The following safety information is provided as a guideline to help you operate your Table Cart under the safest possible conditions. Any tool or piece of equipment can be potentially dangerous to use when safety or safe handling instructions are not known or not followed. The following safety instructions are to provide the user with the information necessary for safe use and operation. Please read and retain these instructions for the continued safe use of your Table Cart. Failure to follow instructions listed below may result in serious injury. In addition, make sure that anyone who uses the equipment understands and follows these safety instructions as well.

### Explanation of Safety Signal Words

**⚠ WARNING:** Indicates a potentially hazardous situation which, if not avoided, could result in death or serious injury.

**⚠ CAUTION:** Indicates a potentially hazardous situation which, if not avoided, may result in minor or moderate injury.

**CAUTION:** Used without the safety alert symbol indicates a potentially hazardous situation which, if not avoided, may result in property damage.

**NOTES:** Provide clarity and helpful information.

Thank you very much for choosing an OEMTOOLS® Product!

For future reference, please register your new tool at [www.oem-tools.com](http://www.oem-tools.com) and complete the owner's record below:

**Model:** \_\_\_\_\_ **Purchase Date:** \_\_\_\_\_

Save the receipt, warranty and these instructions. It is important that you read the entire manual to become familiar with this product before you begin using it. This product is designed for certain applications only. OEMTOOLS® cannot be responsible for issues arising from modification. We strongly recommend that this product is not modified and/or used for any application other than that for which it was designed. If you have any questions relative to a particular application, DO NOT use the product until you have first contacted customer service to determine if it can or should be performed on the product.

**⚠ WARNING:** This product can expose you to chemicals which are known to the State of California to cause cancer and birth defects or other reproductive harm. For more information go to [www.P65Warnings.ca.gov](http://www.P65Warnings.ca.gov).



## 660 LB. DOUBLE-SCISSOR LIFTING TABLE CART

### **! IMPORTANT INSTRUCTIONS AND SAFETY RULES**

1. Know your product. Read this manual carefully. Learn the product's applications and limitations, as well as potential hazards specific to it. The use of this product is simple and straightforward if you follow the instructions. When operating this product, use common sense and only use this product for its intended purpose.
2. Maintain labels and nameplates on this product. These carry important information. If unreadable or missing, contact OEMTOOLS® for a replacement.
3. Maintain this product with care. Keep it dry and clean – and free from brake fluid, oil, and grease (if applicable).
4. Check for damage. Check your product regularly. If part of the product is damaged, it should be carefully inspected to make sure that it can perform its intended function correctly. If in doubt, the part should be repaired. Refer all servicing to a qualified technician. Consult your dealer for advice.
5. Check for misalignment or binding of moving parts, breakage of parts, and any other condition that may affect the product's operation.
6. DO NOT use a damaged product. Tag damaged products "DO NOT USE" until repaired. If damaged, have the product serviced before using. Many accidents are caused by poorly maintained products.
7. Service must be performed only by qualified repair personnel. Service or maintenance performed by unqualified personnel could create a risk of injury.
8. When servicing a product, use only identical replacement parts. Use of unauthorized parts or failure to follow maintenance instructions could create a risk of injury.
9. Use only accessories that are recommended by the manufacturer for your model. Accessories that may be suitable for one product may become hazardous when used on another product.
10. Keep work area clean and well lit. Cluttered or dark work areas invite accidents.
11. Maintain a safe working environment. Keep the work area well lit. Make sure there is adequate surrounding workspace. Keep the work area free of obstructions, grease, oil, trash, and other debris. DO NOT use this product in a damp or wet location.
12. Keep children away from the work area. Never let a child handle this product without strict adult supervision.
13. Store this product out of the reach of children and untrained persons. This product may be dangerous in the hands of untrained users.
14. DO NOT operate this product if under the influence of alcohol or drugs. Read warning labels on prescriptions to determine if your judgment or reflexes are impaired while taking drugs. If there is any doubt, DO NOT attempt to operate.
15. Use safety equipment. Eye protection should be worn at all times when operating this product. Use ANSI approved safety glasses. Everyday eyeglasses are NOT safety glasses. Dust mask, non-skid safety shoes, hard hat or hearing protection should be used in appropriate conditions.
16. Wear proper apparel. Loose clothing, gloves, neck-ties, rings, bracelets or other jewelry may present a potential hazard when operating this product. Keep all apparel clear of the product.
17. DO NOT overreach. Keep proper footing and balance at all times when operating this product.
18. Keep away from flammables. DO NOT attempt to operate this product near flammable materials or combustibles. Failure to comply may cause serious injury or death.
19. Avoid accidental fire and/or explosion. DO NOT smoke near engine fuel and battery components.
20. We believe the information contained herein to be reliable. However, general technical information is given by us without charge and the user shall employ such information at their own discretion and risk. We assume no responsibility for results or damages incurred from the use of such information in whole or in part. Always refer to specific instructions and technical information supplied by vehicle manufacturer.
21. The manufacturer declines any and all responsibility for property damage or injury if said damage is the result of unskillful handling by the operator or of failure to observe the basic safety rules set forth in the instruction manual.
22. The warnings, precautions, and instructions discussed in this manual cannot cover all possible conditions and situations that may occur. The operator must understand that common sense and caution are factors which cannot be built into this product, but must be supplied by the operator.

### **PRODUCT DESCRIPTION**

The OEMTOOLS® 24789 660 Lb. Double-Scissor Lifting Table Cart is a versatile piece of equipment, assisting in the movement of heavy or bulky items around a shop or warehouse.

### **PRODUCT SPECIFICATIONS**

<b>Lift Capacity</b>	600 Lb.
<b>Table Height</b>	Minimum: 13.8" Maximum: 50.6"
<b>Table Dimensions</b>	32.3" L x 20.5" W



## 660 LB. DOUBLE-SCISSOR LIFTING TABLE CART

### SPECIFIC SAFETY INSTRUCTIONS AND WARNINGS

Thoroughly read and understand all instructions in this product manual before using this product. Failure to follow all instructions listed below may result in electric shock, fire, and/or serious personal injury.

#### ▲WARNING

- Use this table for lifting purpose only. DO NOT use it for any other purposes it is not designed to perform.
- The maximum load is 660 Lb. DO NOT exceed this rated capacity.
- Use ONLY on a flat, stable, hard surface.
- DO NOT allow people to sit or ride on the hydraulic table cart.
- DO NOT transports loads with hydraulic table cart in a raised position.
- Be aware of dynamic loading! Sudden load movement may briefly create excess load causing product failure.
- Set the brakes on the rear casters when loading or unloading.
- Lock Casters when unattended.
- Always keep your hands and feet away from moving parts.

#### ASSEMBLY INSTRUCTIONS

1. Place the Table Assembly on a flat surface which is well lighted and safe for assembly operation.
2. Place the Foot Pedal (39) into the Foot Pedal Assembly (33) and fix with Bolt (41).
3. Install the Handle (1) to the Base Assembly (11) and fix with Bolt (21).
4. Your assembly is complete. Use the rubber mat for the tabletop when needed.

#### AIR BLEEDING

**NOTE:** Before using this tool, the pump must be purged of air (called bleeding).

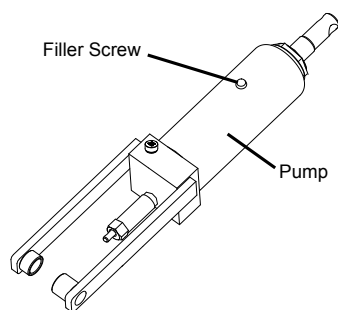

1. Remove any load from the Table.
2. Release the Control Lever, then repeatedly pump the Foot Pedal.
3. When the table has been raised, remove the Filler Screw on the Pump. Keep hands and tools clear, squeeze the Control Lever while pumping the Foot Pedal several times rapidly to lower the Table.
4. Release the Control Lever and pump more slowly to raise the Table to its full height.

5. Add good quality hydraulic oil through the Filler Screw hole until pump will hold no more oil.
6. Replace the Filler Screw and its Seal Washer back to the pump, tighten, but do not overtighten to avoid damaging the Washer.
7. Check the condition of the Hydraulic Lift Table before use. Raise and lower it several times before adding any load. Be sure that all controls work properly.

#### OPERATION INSTRUCTIONS

**▲WARNING:** Use ONLY on flat, stable hard surface

1. Before loading and while stationary, lock the back two casters. The Locking Swivel Casters can be locked by pressing the lever down into the locked position with your foot. Test the cart operation using the Foot Pedal and Control Lever. Make sure the Table raises and lowers properly before adding weight to the Table.
2. Observing safe lifting procedures, move the workpiece onto the cart. Place load in the center of the table. If necessary, secure the item onto the cart using tie-downs or chocks to keep it stable while moving.
3. Lower table before moving the workpiece. Release the Locking Swivel Casters by moving the levers to the unlock position. Move the workpiece to the desired location.
4. Before raising the workpiece, lock the Locking Swivel Casters.
5. To raise the Table, ensure that the Control Lever is in the released position. Press repeatedly on the Foot Pedal to raise the table.
6. After raising the load, turn the safety bar clockwise until it reaches the safety position. Before lowering, please turn the safety bar back.
7. To prevent accidents, when finished using the cart, move the cart to a safe location, lock the Locking Swivel Casters and lower the Table as far as it will go. Clean, then store the cart indoors out of reach of children.



## 660 LB. DOUBLE-SCISSOR LIFTING TABLE CART

### PRODUCT MAINTENANCE

**⚠WARNING:** Procedures not specifically explained in this manual must be performed only by a qualified technician.

#### TO PREVENT SERIOUS INJURY:

Remove load from Lift Table before service. Lower table when possible before service.

#### TO PREVENT SERIOUS INJURY FROM TOOL FAILURE:

DO NOT use damaged equipment. If abnormal noise or vibration occurs, have the problem corrected before further use.

1. **BEFORE EACH USE**, inspect the general condition of the tool. Check for loose hardware, misalignment or binding of moving parts, cracked or broken parts, damaged electrical wiring, and any other condition that may affect its safe operation.
2. When not in use the table must be stored in the lowest position in a dry location to minimize ram and piston corrosion.
3. Store your Hydraulic cart in a location where it is protected from moisture, dirt and corrosive atmosphere. Protect it from being damaged from other items being moved in and out of its storage area.
4. Occasionally apply light grease to the hinge points of the Scissor Arm Assembly and other pivot points of the assembly. Wipe off excess grease as this will attract dirt.
5. Check the hydraulic oil level. If it is not adequate, remove the oil plug on the hydraulic pump and add Grade A hydraulic oil as necessary.  
**⚠WARNING:** DO NOT use brake fluid or any other improper fluid. Only a good quality hydraulic jack oil can be used. Every time after adding hydraulic oil, bleed the hydraulic ram with instructions on page 3.
6. DO NOT overload this cart, as that may cause damage to the seals. If the Table will not raise or slowly lowers, the cause may be damaged seals or low hydraulic oil level. To fix this condition, first try the bleeding technique discussed on page 4. If that doesn't work, take the Hydraulic Table Cart to a qualified technician for repair.
7. Occasionally check the condition of the wheels. They should be kept free of grease and oil, which may damage the rubber tires. Occasionally add grease to the grease fittings on each wheel.
8. **AFTER USE**, wipe external surfaces of the tool with a clean cloth.

### DISPOSAL

At the end of the useful life of the 660 Lb. Double-Scissor Lifting Table Cart, dispose of the components according to all state, federal, and local regulations.





# 660 LB. DOUBLE-SCISSOR LIFTING TABLE CART

## PRODUCT LAYOUT

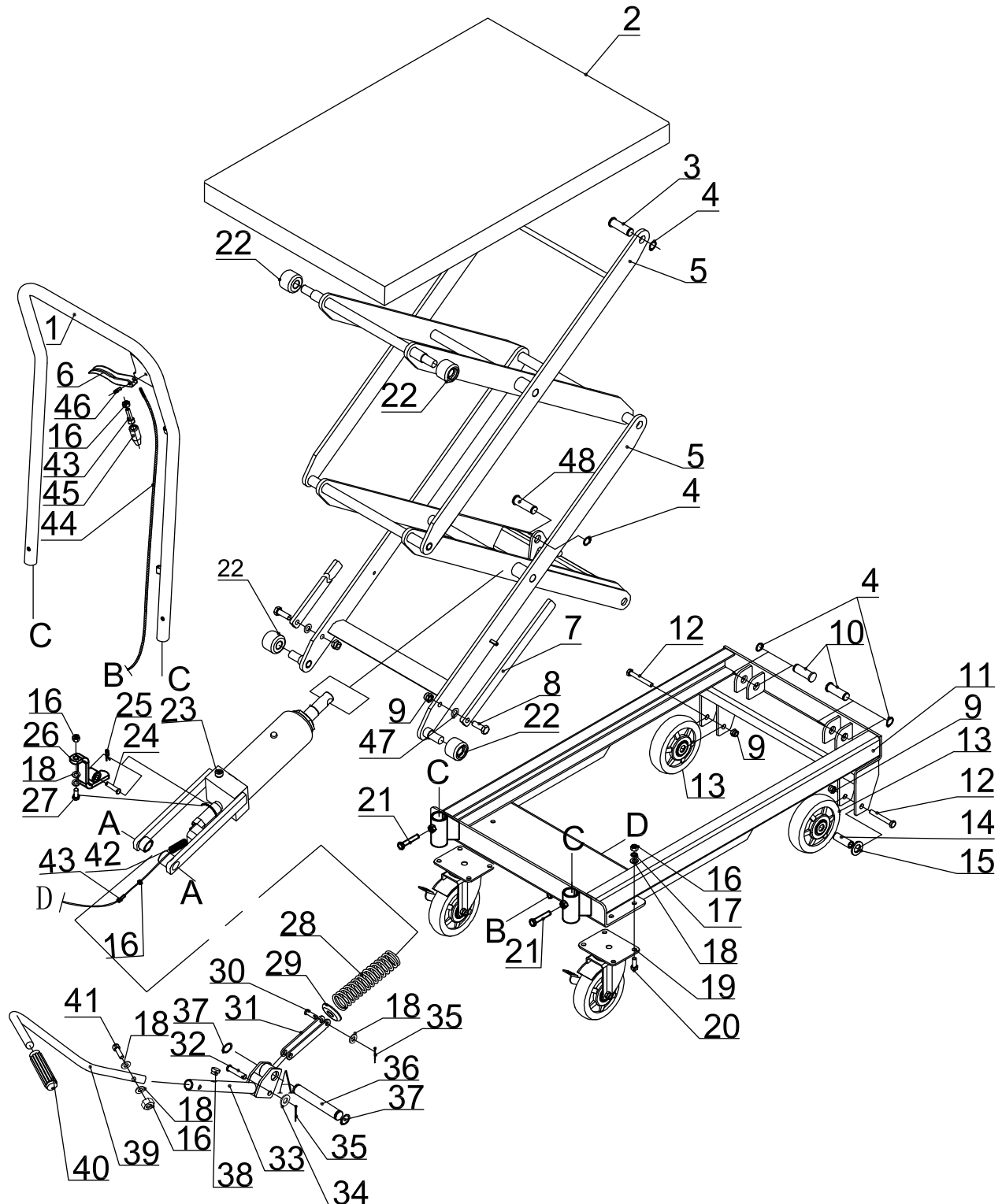



## 660 LB. DOUBLE-SCISSOR LIFTING TABLE CART

### PARTS LIST

Figure	Description	Qty.
1	Handle	1
2	Lifting Plate	1
3	Pin	3
4	Retain Ring	5
5	Support	1
6	Control Lever	1
7	Safety Bar	2
8	Bolt	2
9	Nut	4
10	Pin	2
11	Base Assembly	1
12	Bolt	2
13	Fixed Wheel	2
14	Fixed Wheel Bushing	2
15	Flat Washer	4
16	Nut	12
17	Lock Washer	8
18	Flat Washer	13
19	Casters	2
20	Bolt	8
21	Bolt	2
22	Roller	4
23	Pump	1
24	Pin	1
25	R-Pin	1
26	Connecting Rod Assembly	1
27	Screw	1

Figure	Description	Qty.
28	Spring	1
29	Cover	1
30	Pin	1
31	Connect Plate	1
32	Pin	1
33	Foot Pedal Assembly	1
34	Flat Washer	1
35	R Pin	2
36	Pin	1
37	Retain Ring	2
38	Rubber Screw	1
39	Foot Pedal	1
40	Rubber Sleeve	1
41	Bolt	1
42	Spring	1
43	Screw	2
44	Steel Cable	1
45	Steel Cable Sheath	1
46	Pin	1
47	Flat Washer	2
48	Pin	1

**NOTE:** Not all components are replacement items, but are illustrated as a convenient reference for location and position in the assembly sequence.



## 660 LB. DOUBLE-SCISSOR LIFTING TABLE CART

### WE STAND BEHIND OUR TOOLS. OEMTOOLS® 1 YEAR WARRANTY

If within 1 year from the date of purchase of this OEMTOOLS product, you find any defect in material or workmanship, through normal usage, return it to the place of purchase or to OEMTOOLS® for repair or replacement at our discretion. In order to obtain this service, send your tool and proof of purchase (transportation pre-paid) to:

OEMTOOLS® Q.A. Dept., 3580 E. Raines Road #3, Memphis, TN 38118.

We will not be responsible for lost or damaged goods during transportation; please insure your package. If our inspection verifies the defect, we will repair or replace the product, or we may elect to refund the purchase price if we cannot readily and quickly provide you with a replacement. We will return repaired products at our expense, but if we determine there is no defect, or that the defect resulted from causes not within the scope of our warranty, then you must bear the cost of returning the product.

OEMTOOLS® does not provide warranty for products labeled other than OEM® or OEMTOOLS®. OEMTOOLS® will not provide any warranty for products subjected to abnormal use. Abnormal use includes (but is not limited to) abuse, accident, alteration, neglect, and unauthorized or unreasonable use or repairs. This warranty does not cover bits, blades, files, batteries, or calibration. We recommend that you maintain your tools and sharpen or replace blades, bits, files, and batteries as necessary. OEMTOOLS® reserves the right to make any changes in construction or design at any time without any obligation in incorporating such changes to tools or equipment previously sold.

OEMTOOLS® makes every effort to ensure that its products meet high quality and durability standards, and warrants to the original purchaser that this product is free from defects in materials and workmanship. This warranty does not apply to damage due directly or indirectly to misuse, abuse, negligence or accidents, repairs or alterations outside our facilities, criminal activity, improper installation, normal wear and tear, or to lack of maintenance.

We shall in no event be liable for death, injuries to persons or property, or for incidental, contingent, special or consequential damages arising from the use of our product. Some states do not allow the exclusion or limitation of incidental or consequential damages, so the above limitation of exclusion may not apply to you. THIS WARRANTY IS EXPRESSLY IN LIEU OF ALL OTHER WARRANTIES, EXPRESS OR IMPLIED, INCLUDING THE WARRANTIES OF MERCHANTABILITY AND FITNESS. This warranty gives you specific legal rights, and you may also have other rights, which vary from state to state.

Please contact us at [customerservice@oem-tools.com](mailto:customerservice@oem-tools.com) or call us at 901-370-1101 for additional information or questions.

Thank you for your purchase.

## CONTACT US

3580 E. Raines Road, Suite 3, Memphis, TN 38118  
Tel: 1-866-458-2472  
[www.oem-tools.com](http://www.oem-tools.com)